

Vedere A - A

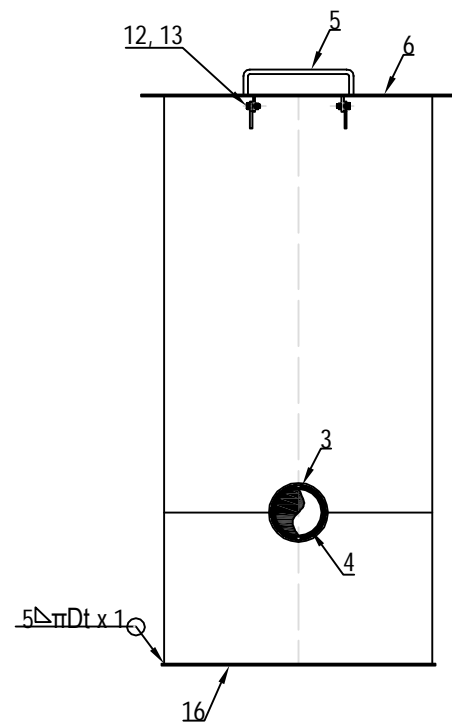

Detaliu izolare ventil si montaj tub protector

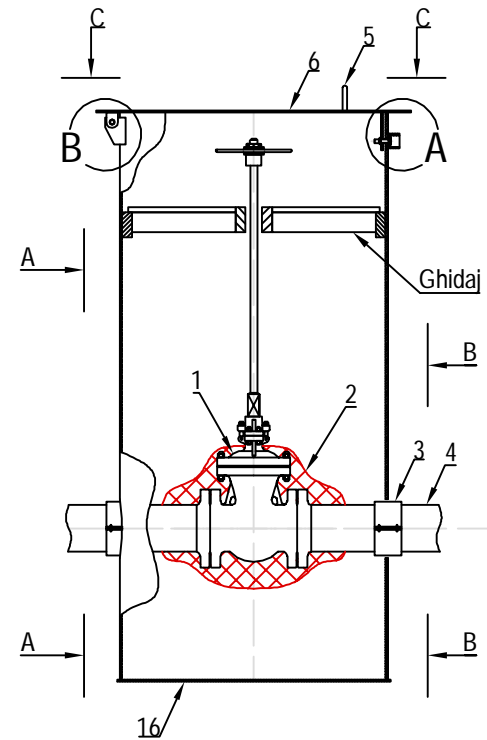

Vedere B - B

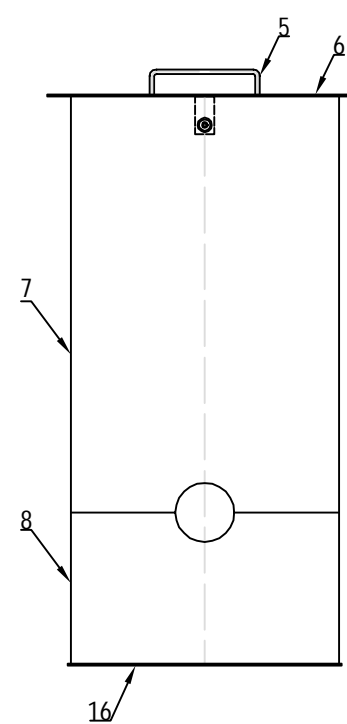

Vedere in plan C - C

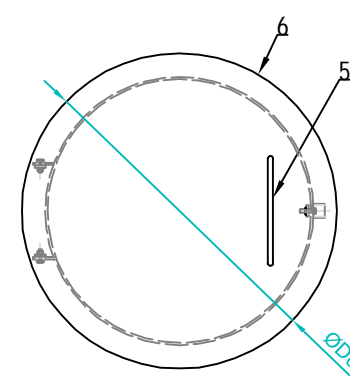

Detaliu "6"

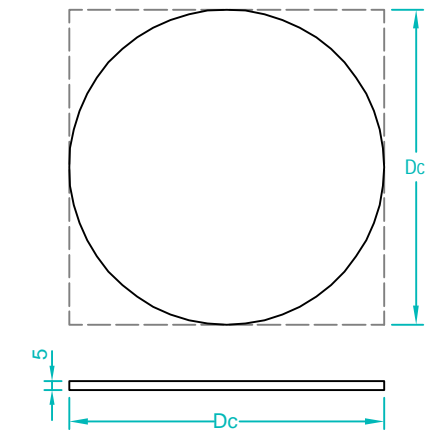

Detaliu tub superior "7"

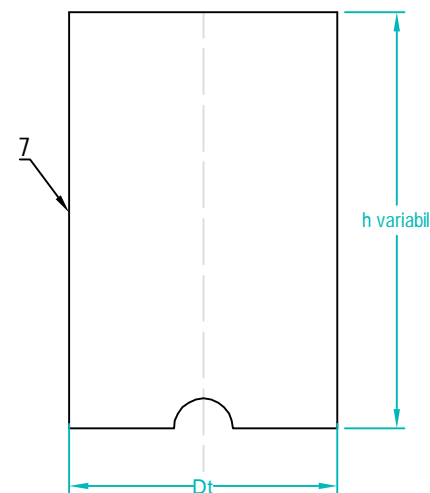

Detaliu tub inferior "8"

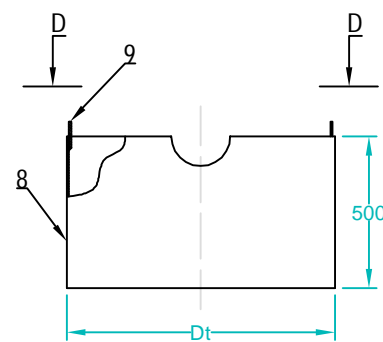

Vedere D - D

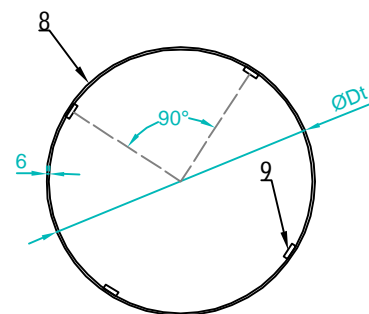

Detaliu "16"

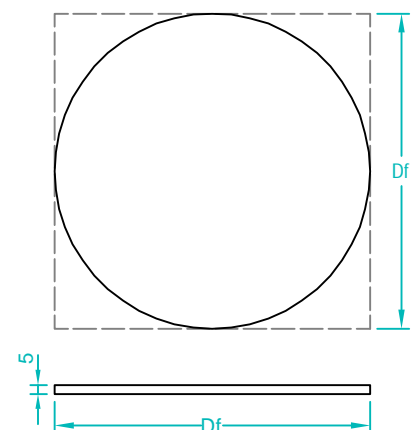

NOTA:  
 Protectia anticoroziva a caminului se va face prin vopsire conform SR EN ISO 12944:2002  
 - doua straturi grund epoxidic cu Zn, cu grosime totala strat uscat 75 - 80 µm;  
 - vopsea epoxidica clorcauciuc in doua straturi.

Dimensiuni tub protector				
DN ventil	Dt	Grosime tub [mm]	Dc	Df
200	914	7.1	986	986

Poz.	Denumire	Dimensiuni	STAS	Material	Cantitati
1	Robinet cu sertar pana	DN 200		A216 + 13Cr	
2	Mastic izolator		KEBU PLAST MASTIC		
3	Inel distantier			MDPE	2
4	Teava		SR EN ISO 3183/2020	L 360N	
5	Maner	Ø12 x 400mm	SR EN 10060:2004	OL 37.2K	1
6	Capac	Tb. 5mm	SR EN 10029:2011	OL 37.2K	1
7	Manta camin superioara	ØDt x 7.1	SR EN ISO 3183/2020	L 245N	
8	Manta camin inferioara	ØDt x 7.1 x 500mm	SR EN ISO 3183/2020	L 245N	
9	Platbanda ghidare tub	100 x 40 x 5mm	SR EN 10058:2004	OL 37.2K	4
10	Protector surub	Ø1 1/2" x 3.6 x 30mm	STAS 8185:88	OLT 45	1
11	Tabla groasa	100 x 50 x 6mm	SR EN 10058:2004	OL 37.2K	1
12	Surub	M10 x 50	SR EN ISO 4018:2011		3
13	Piulita	M10	SR EN ISO 4034:2013		3
14	Tabla groasa	70 x 55 x 6mm	SR EN 10058:2004	OL 37.2K	2
15	Tabla groasa	40 x 30 x 6mm	SR EN 10058:2004	OL 37.2K	2
16	Fund camin	Tb. 5mm	SR EN 10029:2011	OL 37.2K	1

GREUTATE CAMIN IN FUNCTIE DE INALTIME

Greutate capac camin [Kg]	42.54	42.5	42.5	42.5	42.5	42.5	42.5	42.5	42.5	42.5
Greutate fund camin [Kg]	42.54	42.5	42.5	42.5	42.5	42.5	42.5	42.5	42.5	42.5
Greutate tub pe ml [Kg]	159	159.0	159.0	159.0	159.0	159.0	159.0	159.0	159.0	159.0
H [m]	1.5	2.0	2.5	3.0	3.5	4.0	4.5	5.0	5.5	6.0
Greutate [Kg]	334.6	414.1	493.6	573.1	652.6	732.1	811.6	891.1	970.6	1050.1

Verificator/  
Expert

Nume

Semnatura

Cerinta

Referat / Expertiza Nr. / Data

S.C. SNIF PROIECT S.A. Targoviste  
S.C. ATANASIU PROIECT S.R.L.Beneficiar:  
CONPET S.A. PLOIESTIPr. nr.  
393/2020

Specificatie

Nume

Semnatura

Scara:

"Inlocuire conducta de titei F1 8 5/8" Ticleni - Barbatesti, in  
punctul drum acces rezervor apa Primaria Barbatesti,  
aproximativ 200 m"Faza  
PT+CS+DE

Desenat

Ing. Radu Florin

Data:

2020

Detaliu izolare ventil si montaj tub protector

Pl. nr.  
14